

# QUICK START

## CARRIER 20 CART™ (MK5)



VIDEO INSTRUCTIONS:  
<https://vimeo.com/176129931>



DETAILED INSTRUCTIONS:  
Visit our website and press the support button.

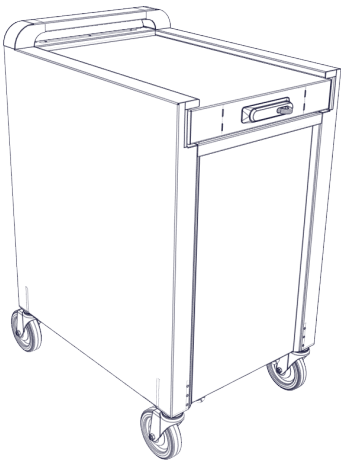

x1



x1

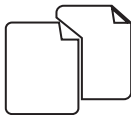

x2



x1



x20

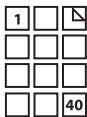

x2



x1



x4

1

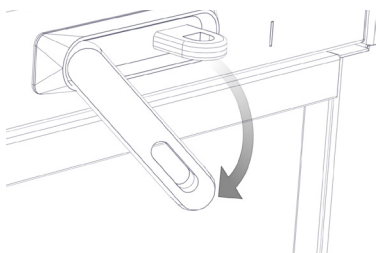

2

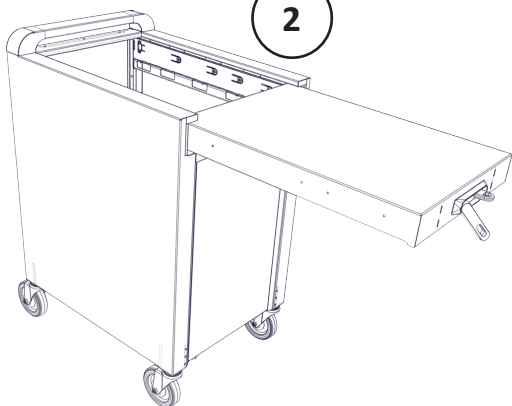

3

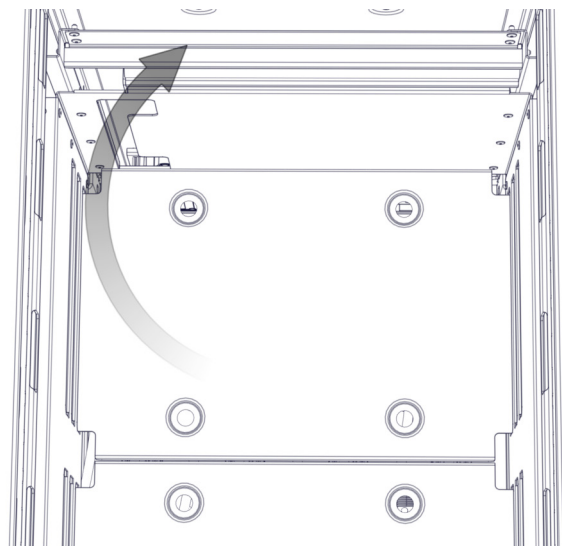

4

Europe only - install Power Tray

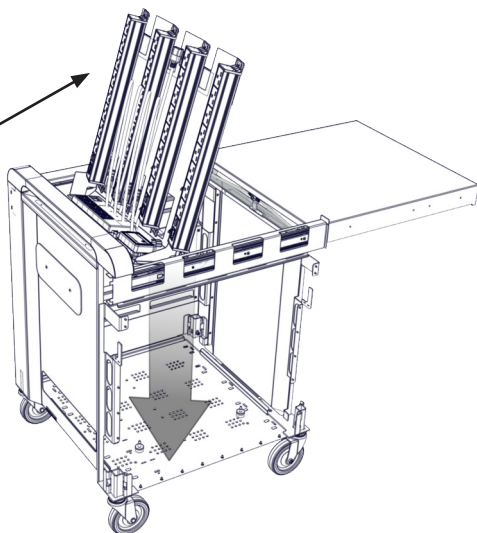
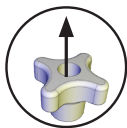
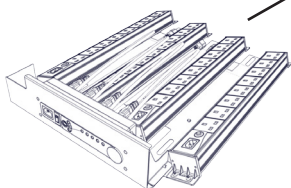

5

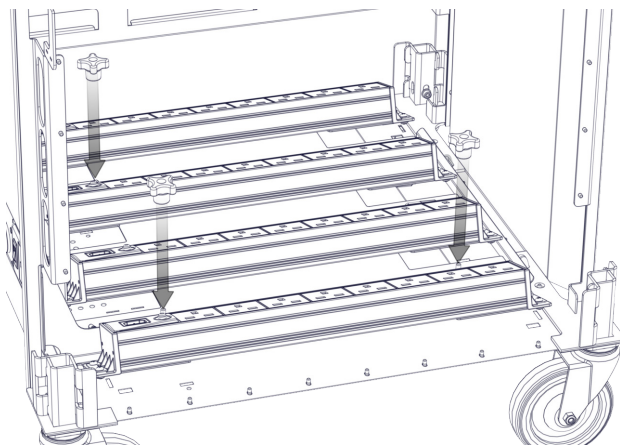
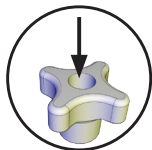

6

Connect chargers and  
install device cables

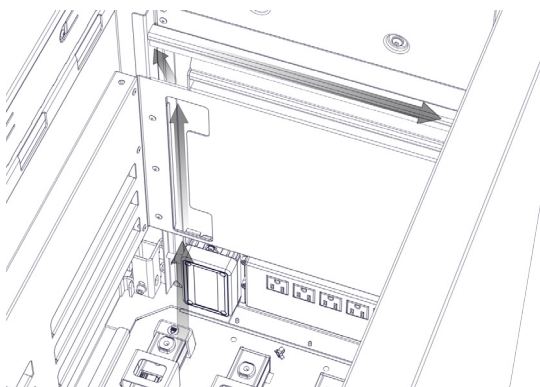

7

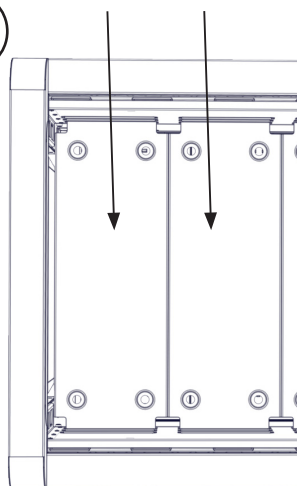

8

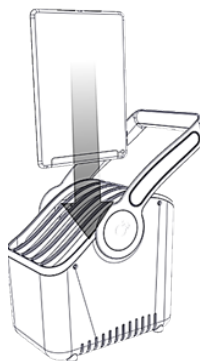

9

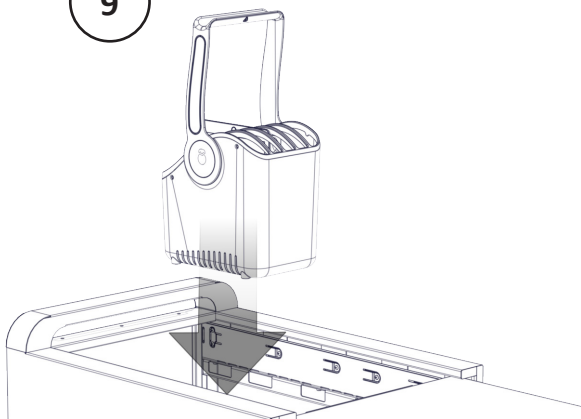

10

## Lock and charge

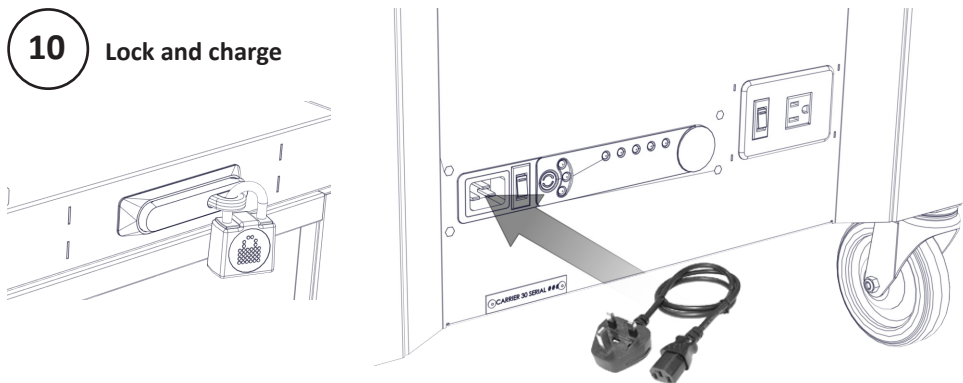

11

## Using ECO Safe Charge™



**ADDITIONAL INSTRUCTIONS:**  
Detailed instructions included in the box.



**VIDEO INSTRUCTIONS:**  
<https://vimeo.com/194627704>



**DETAILED INSTRUCTIONS:**  
Visit our website and press the support button.

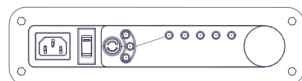

12

## Manage your devices

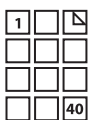

**USE NUMBERED STICKERS:**  
Organise your device with the supplied stickers.



**BUNDLE YOUR CORDS/CABLES:**  
Use the velcro straps supplied to manage your device cables.

13

## Visit our website for more details



**VISIT:**  
[www.lockncharge.com](http://www.lockncharge.com) (International site)  
[www.pclocs.com.au](http://www.pclocs.com.au) (Australia and New Zealand)